

Product Installation Guidelines & Scope of Use

Version 3.1, 30 July 2025, Page 1 of 6
Document No.: 001.00.70.05

BS Lead Safe™ Lever Action SBA

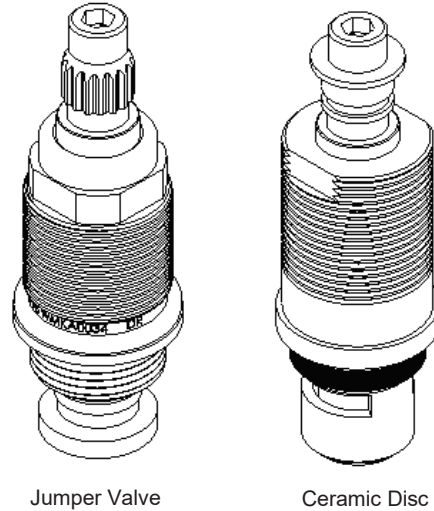

Jumper Valve

Ceramic Disc

Product Codes	Description	Headworks
181.94.51.01	BS Lead Safe™ Lever Action Pre-Rinse Hob TF83/84 SBA J/V - Cold	Jumper Valve
181.94.31.02	Ezy-Wash® BS Lead Safe™ Lever Action Pre-Rinse TF83/85 Hob SBA J/V - Hot	Jumper Valve
181.94.12.01	BS Lead Safe™ Lever Action Pre-Rinse SBA Cold C/D	Ceramic Disc
181.94.12.02	BS Lead Safe™ Lever Action Pre-Rinse SBA Hot C/D	Ceramic Disc
181.94.42.02	BS Lead Safe™ Lever Action Pre-Rinse Twin TF70/84 Mixer SBA Hot C/D	Ceramic Disc
181.94.32.02	BS Lead Safe™ Lever Action Pre-Rinse SBA TF85-C Hot C/D	Ceramic Disc
181.94.52.01	BS Lead Safe™ Lever Action Pre-Rinse TF70/84 Hob Unit SBA C/D - Cold	Ceramic Disc
181.94.11.01	BS Lead Safe™ Lever Action Pre-Rinse TF82HOB SBA Cold J/V	Jumper Valve
181.94.11.02	BS Lead Safe™ Lever Action Pre-Rinse TF82HOB SBA Hot J/V	Jumper Valve
181.94.41.02	BS Lead Safe™ Lever Action Pre-Rinse TF81/84 SBA Hot J/V	Jumper Valve

SPECIFICATIONS

- Ezy-Wash® Pre-Rinse units are designed to clear excess food debris and sauces off dishes before placing them in commercial dish washing machines.
- Lever action SBA's include ceramic cartridge/jumper valve components.
- Lead Safe brass™ construction. *

IMPORTANT: All Ezy-Wash® taps are tested in accordance with AS 3718 and leave our premises in good working order.

*Our Lead Safe™ product range is compliant with the Lead-Free Requirements of the NCC 2022 Vol. Three, Clause A5G4(2) and NSF/ANSI 372.

** Any flow controller incorporated in the outlet to be tightened to prevent removal by hand. As Per AS3718.

WARNINGS: Special attention to be paid to notes, photos, images, or drawings of assembly steps marked with the warning symbol.



TECHNICAL DATA

Inlet	G 5/8" – Male	
Working Pressure Range (kPa)	Min	50
	Max	500
Working Temperature (°C)	Min	5
	Max	65
Finish	Brass	

NOTE: Galvin Engineering continually strive to improve their products. Specifications may change without notice.

TOOLS REQUIRED

- Spanner and hex key
- Thread tape

DIMENSIONS

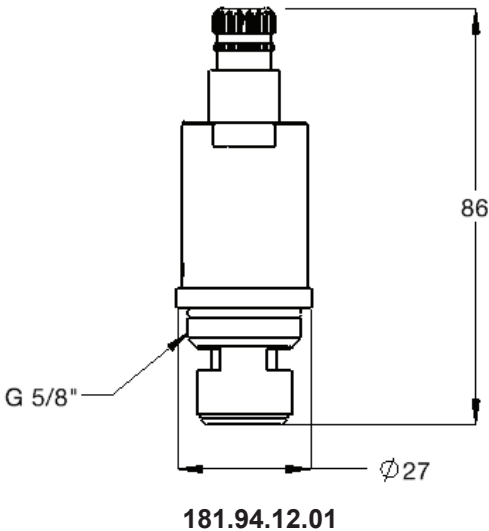
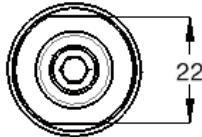
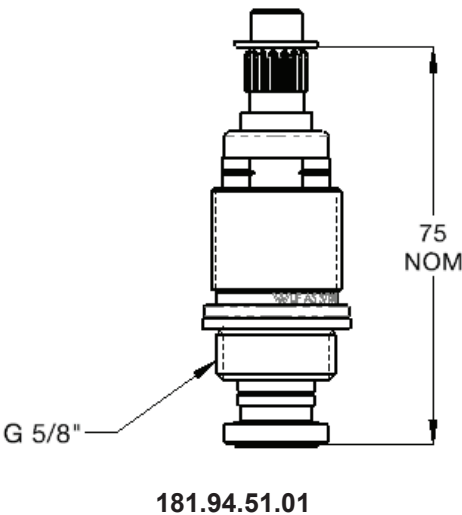
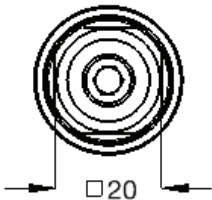

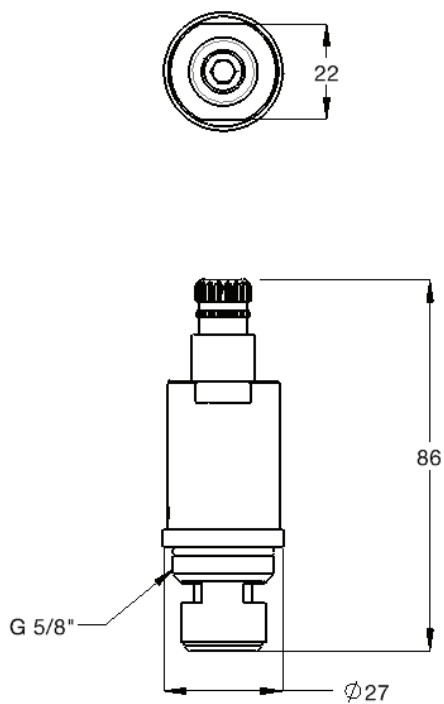

181.94.12.02

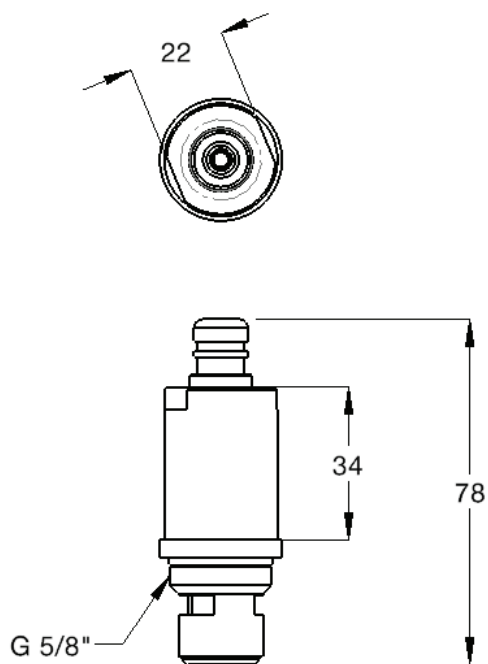

181.94.42.02

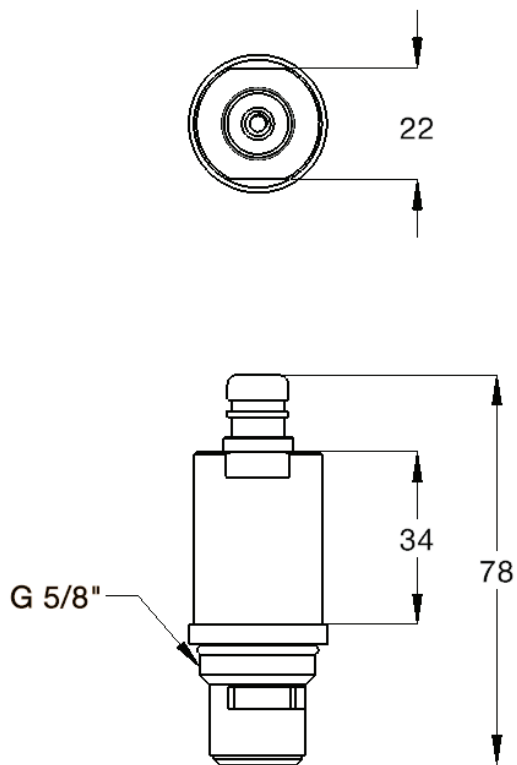

181.94.32.02

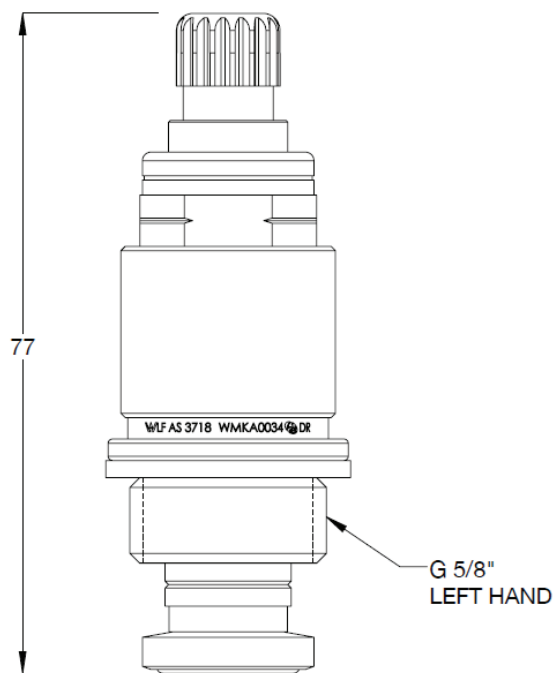

181.94.31.02

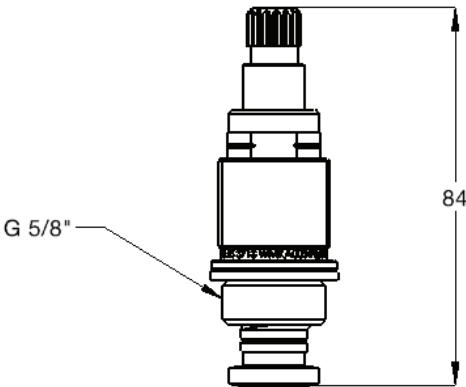
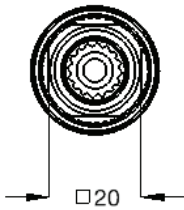

181.94.11.01

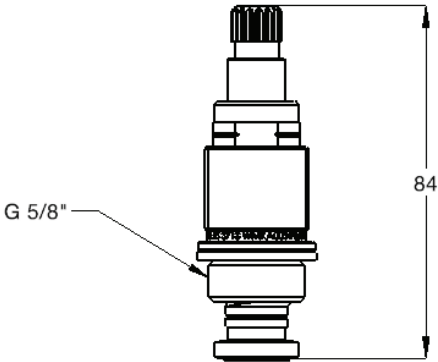
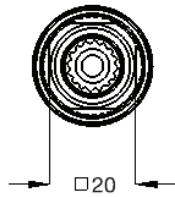

181.94.11.02

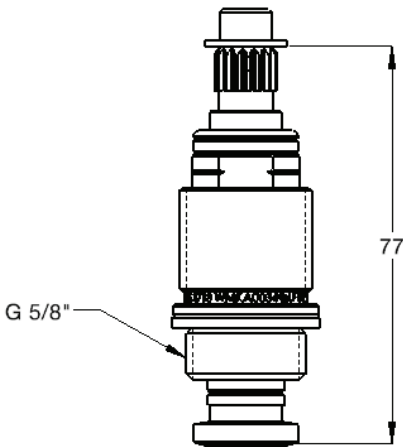
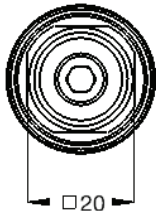

181.94.41.02

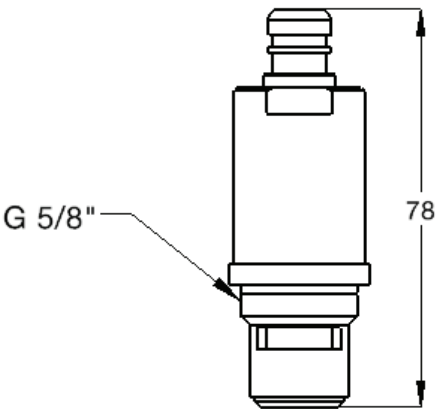
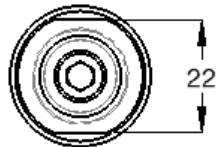

181.94.52.01

INSTALLATION

INSTALLATION COMPLIANCE: Galvin Engineering products must be installed in accordance with these installation instructions and in accordance with AS/NZS 3500, the PCA and your local regulatory requirements. Water and/or electrical supply conditions must also comply to the applicable national and/or state standards. Failing to comply with these provisions shall void the product warranty and may affect the performance of the product.

⚠ Note: Tapware body used as an example only. SBAs can fit on different kinds of bodies where applicable.

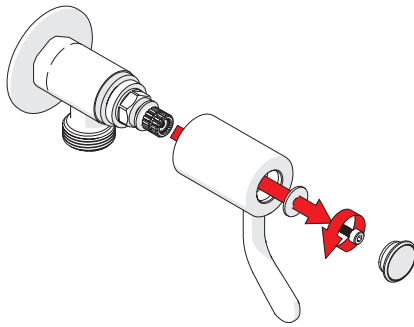
**1. Remove Handle**

- Prior to installation turn off the water supply.
- Remove the handle assembly. To prevent damage, carefully pry off plastic indicator from the handle. (Use a small flat bladed screwdriver if necessary).

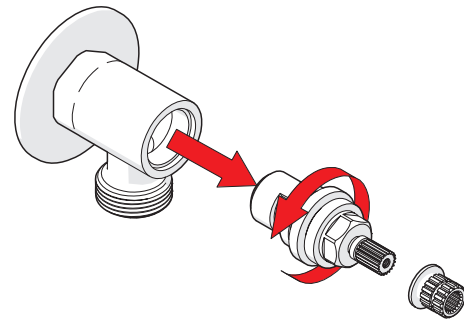
**2. Replace spindle assembly**

- Unscrew the head part from the threaded sleeve using a suitable spanner.
- Check seat inside tap body for pitting or damage. Re-seat if necessary

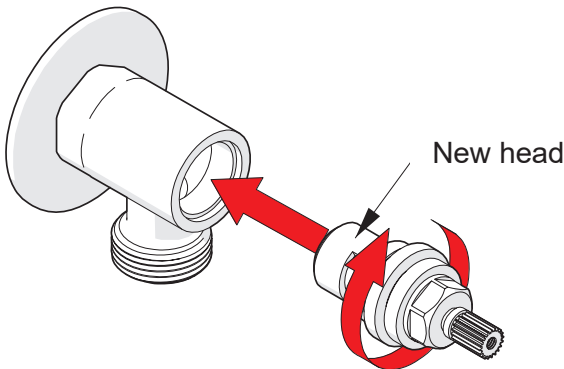
**3. Refit new head**

- Refit new head into tap body.

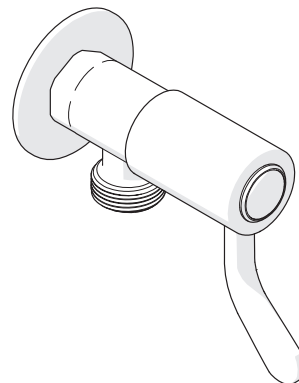
**4. Reassemble Handle**

- Refit adaptor and reassemble handle by reversing step 1 and 2.
- When installation is complete, slowly open water supply and inspect for leaks.

⚠ Note: Do not tighten cartridge using the handle as this will result in damage to the cartridge.

TROUBLESHOOTING

PROBLEM	CAUSE	RECTIFICATION
Taps are dripping water	Jumper valves are worn or damaged	Replace jumper valve
	Ceramic discs are worn or damaged	Remove and inspect SBA. Remove debris and/or replace SBA if damaged.
	Tap seat is damaged	Refurbish tap seat using a reseating tool.
Water is leaking from spindle	O-ring on jumper valve spindle is damaged or worn	Replace o-ring
Water is not flowing from tap	Water supply is turned off	Turn on water supply
	Ceramic Discs/Jumper Valves are worn or damaged	Remove and inspect SBA. Remove debris and/or replace SBA if damaged.
Spindle is difficult to turn	Ceramic Discs/Jumper Valves are worn or damaged	Remove and inspect SBA. Remove debris and/or replace SBA if damaged.
	Build up of scale on spindle, spindle worn or O-ring has been damaged	Remove jumper valve, clean and regrease. Replace O-ring. Complete SBA may need to be replaced.
Handle is loose	Screw has come loose	Tighten handle screw

WARRANTY

Galvin Engineering products are covered under our Manufacturer's Warranty. Galvin Engineering products must be installed in accordance with the installation instructions and in accordance with AS 3500 and NCC Volume Three, relevant Australian Standards and local authorities applicable to product being installed. Water and electrical supply conditions must also comply to the applicable national and/or state standards, failing to comply with these provisions may void the product warranty and affect performance of the product.

Please visit www.galvinengineering.com.au to view the full warranty, our Installation Compliance and Maintenance & Cleaning information as well as any other additional information.

Within Australia: **1300 514 074** Outside Australia: P: **+61 (0)8 9338 2344**

F: **+61 (0)8 9338 2340**

sales@galvinengineering.com.au

www.galvinengineering.com.au

ABN: 78 008 719 382

PERTH | SYDNEY | MELBOURNE | BRISBANE | ADELAIDE

